

# AUGER COMPACTORS

**Superior volume reduction,  
lower maintenance cost.**

**Processes waste faster.**



*AST-440 Twin Auger*



*ASC-210 Auger*



*AST-220 Auger*

**RAMJET**   
Stationary and self-contained compactors.



**Environmental  
Solutions Group**

A DOVER COMPANY

# ASC-210 Self-Contained Auger Compactor

*Easy to use and maintenance-friendly*

*Always moves material forward*

*Ideal for wet waste such as medical or organic, but heavy duty construction allows for waste like skids and pallets*

*Whisper quiet*

*Eliminate all hydraulics*



Marathon's ASC-210 Auger Compactors are easy to use and maintenance friendly. Features such as the short tail for dock feeding, or rear feeding, and the innovative design which eliminates springback into the auger chamber, all add up to a reliable auger compactor for years of trouble-free performance.

The advantages of using an using an Auger Compactor:

- ✔ Increased payloads reduce transportation costs
- ✔ Minimize waste storage space on site
- ✔ Continuous forward auger blade movement eliminates waste sitting in charge chamber, no cavities where waste can build up

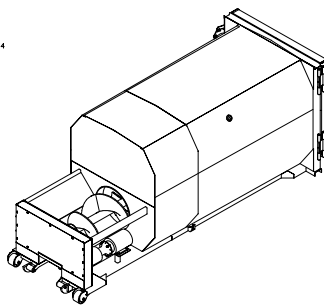
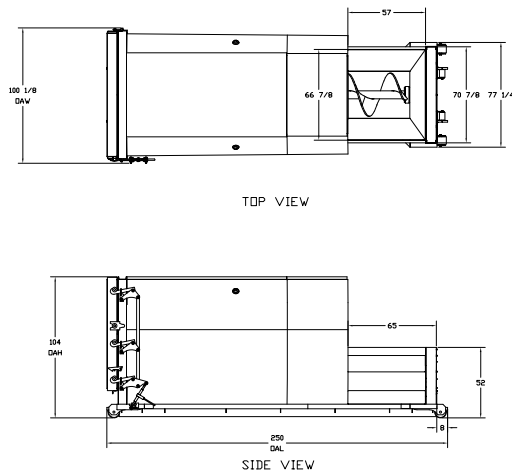

### ASC-210 Specifications:

Weight (30 yd <sup>3</sup> )	4,100 lbs	1,850 kg
Auger diameter	36"	900 mm
Penetration	13"	330 mm
Performance characteristics		
Auger speed	9 rpm	
Cycle time	13 sec	
Displacement rate	305 yd <sup>3</sup> /hr	235 m <sup>3</sup> /hr
Electrical equipment		
Electric motor	10 hp	11 kw
3/60/230-460		

# AST-220 Stationary Auger Compactor

*Easy to use and maintenance-friendly*

*Always moves material forward*

*Higher payloads on materials such as OCC up to eight tons in a 40-yard container*

*Whisper quiet*



Marathon highly recommends using the optional Round Opening Container Adapter Plate. This option is quickly and easily added to a standard rectangular container opening, and helps to assure clean container break away with the least possible spillage of any stationary compactor.

Marathon's Stationary Auger Compactors are specifically designed for superior compaction and lower maintenance. The Stationary Compactor is best suited for dry waste, such as paper and cardboard.

The advantages of using an using an Auger Compactor:

- ▼ Continuous forward auger blade movement yields excellent payloads, some OCC applications as high as 8 tons in a 40-yard receiver container
- ▼ Superior compaction
- ▼ Eliminates springback

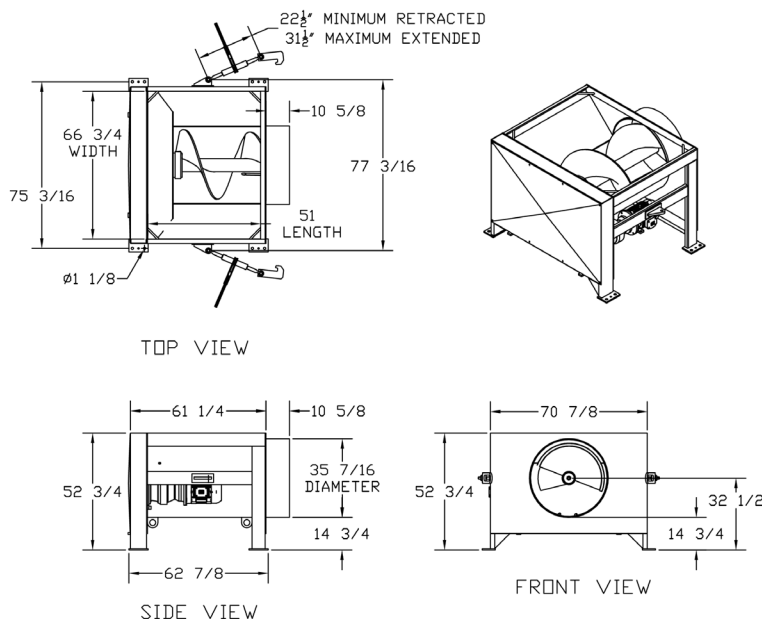

AST-220 Specifications:		
Weight	4,250 lbs	1,925 kg
Auger diameter	36"	900 mm
Penetration	11"	265 mm
Performance characteristics		
Auger speed	14 rpm	
Cycle time	8.5 sec	
Displacement rate	425 yd <sup>3</sup> /hr	325 m <sup>3</sup> /hr
Electrical equipment		
Electric motor 3/60/230-460	20 hp	15 kw

# AST-440 Twin Auger Compactor

*Easy to use and maintenance-friendly*

*Always moves material forward*

*Higher payloads on materials such as OCC, wooden pallets and crates, and dry other waste*

*Ideal for volume reduction of bulky items such as furniture*

*Whisper quiet*

*Deck height of only 48" makes loading more convenient than competitive single auger compactors, which are much higher*



The AST-440 Stationary Auger Compactor is a heavy-duty machine specifically designed for compacting large volumes of waste material. As a Stationary Compactor, the machine is best suited for dry waste such as paper, cardboard, wooden pallets, etc. This Twin 28" Auger has excellent throughput. It's able to process large bulky items without bridging in the hopper and is commonly used for large industrial sites and production lines.

The advantages of using an using a Twin Auger Compactor:

- ✔ Increased payloads reduce transportation costs
- ✔ Minimize waste storage space on site
- ✔ Ideal for material destruction and reduction of wooden pallets, crates and furniture

# TWIN AUGER

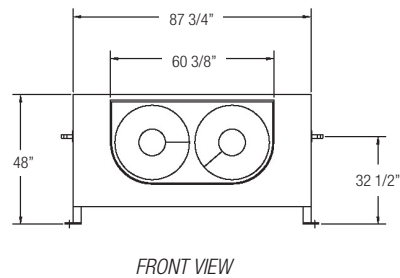
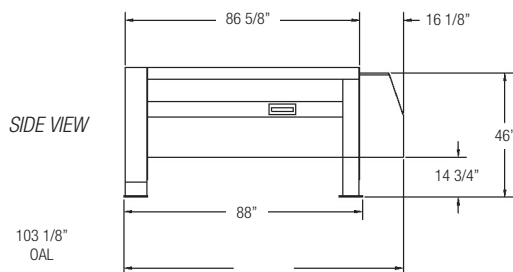
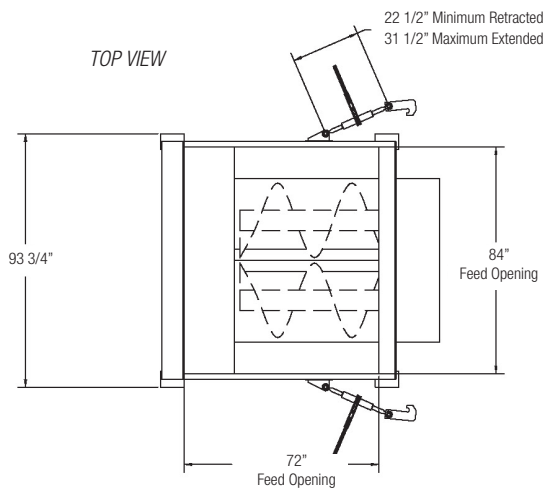

## AST-440 Specifications:

Weight	9,500 lbs	4,300 kg
Auger diameter	2 x 28"	2 x 600 mm
Penetration	xx"	xxx mm
Performance characteristics		
Auger speed	8 rpm	
Cycle time	xx sec	
Displacement rate	xxx yd <sup>3</sup> /hr	xxx m <sup>3</sup> /hr
Electrical equipment		
Standard voltage	460 volt, 3-phase other voltages available	

## National Joint Powers Alliance® Awarded Contract

National Joint Powers Alliance (NJPA) has awarded Environmental Solutions Group (ESG), of which Marathon is a part, a national contract for “Solid Waste and Recycling Collection Equipment with Related Equipment, Accessories, and Supplies.”

NJPA is a municipal contracting government agency that serves education and government agencies and non-profit organizations nationally through competitively bid and awarded contract purchasing solutions. Over 45,000 members enjoy the value and commitment of more than 100 world-class NJPA awarded vendors.

Avoid a lengthy and costly bid process. Take advantage of national competitively bid and awarded contract purchasing solutions. Membership is free and applies to all ESG brands, including Heil, Marathon, Bayne, and Curotto-Can.



Contract #060612-ESG



### Compactor Rental and Leasing Programs Available

For detailed specifications, recommendations, or free economic studies comparing various systems, contact Marathon Customer Care at **(800) 269-7237**.



**Authorized Dealer:** Action Compaction Equipment, LLC  
1042 E. Fort Union Blvd. #260  
Midvale, UT. 84047  
801-565-1033  
[www.actioncompaction.com](http://www.actioncompaction.com)



**Marathon Equipment Company**  
P.O. Box 1798  
Vernon, AL 35592-1798  
800.633.8974  
[www.marathonequipment.com](http://www.marathonequipment.com)  
NJPA Contract #060612-ESG



Pictures in this literature are illustrative only. Specifications are subject to change without notice in order to accommodate improvements to the equipment. Complies with ANSI standard Z245.2, and applicable OSHA Regulations. Products must be used with safe practice and in accordance with said operator manual and applicable regulations and standards. \*UL listed Panel Box only.